

© COPYRIGHT 2022 BY INDUSTRIAL FIBER OPTICS, INC.
ALL RIGHTS RESERVED.

REVISIONS

REV	DESCRIPTION	ECO	DATE	DWN	APVD
A	Initial Release		6/25/2019	DDH	
B	Replaced TCU-1000(L) with TCU-1000	00381	9/25/2020	DDH	
C	Added note regarding material substitution, removed IF 3L18	00417	8/15/2022	BB	DDH

LENGTH	TOLERANCE
0.1m	+0.03;-0.0m
0.2-0.99m	± 0.03m
1-5.49m	± 0.05m
5.5-12.99m	± 0.1m
13-29.99m	± 0.15m
30-50m	± 0.3m
50.1 - 80	± 0.5m

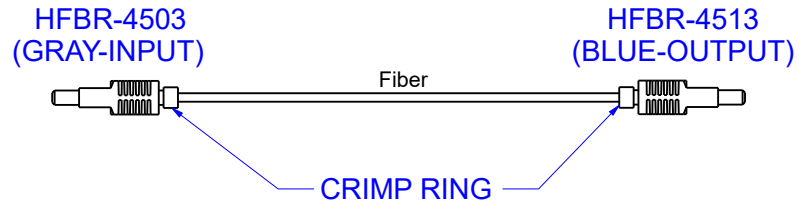
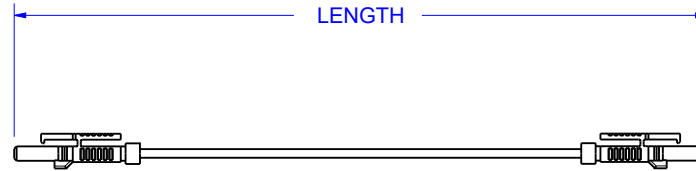

*The fiber cable used for the assembly will be based upon the category of cable used for the SERIES. Asahi Kasei and Mitsubishi Eska optical fiber cable are shown, however other manufacturers' cable may be used based on availability.

SERIES	FIBER*
IF 1L1N	TCF-1000 GHCP4001
IF 1L1L	TC-1000 GH4001
IF 1L1M	TCV-1000 GHV4001
IF 1L1O	GHN4001
IF 1L1Q	GHTT4001
IF 1L1V	BH4001 SHCN-1000(E)
IF 1L1D	DC-1000 SH4001

UNLESS OTHERWISE SPECIFIED		PRODUCT		Industrial Fiber Optics TEMPE, AZ 85281			
DIMENSIONS	MILLIMETERS [IN.]	MATERIAL	N/A	NAME Simplex Latching Versatile Link Cable Assembly			
		FINISH	NONE				
DIMENSIONS ARE FOR REFERENCE ONLY NO TOLERANCES MAY BE IMPLIED FROM THIS DOCUMENT		DRAWN BY	David Hanson	SIZE	SCALE	DOCUMENT NUMBER	REV
		DATE	6/25/2019	A	1:2	IF 1L1x	C
		CHECKED BY	B. Bidwell	DO NOT SCALE DRAWING		1 OF 1	
		DATE	8/15/2022				

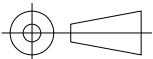

METRIC